

# HYBRID LIGHT BAR & FAST FIT WIRING HARNESS

## INSTALLATION GUIDE

### Important

1. The wiring harness installation is the same for both single & double row lightbars, only the under mount brackets are different.
2. This is an electrical installation. If you are not confident working with automotive wiring, engage a qualified auto electrician.
3. Check the contents of kit before commencing fitment and contact ALTIQ™ Support if there are any issues.
4. These instructions must be followed in full for warranty to be upheld.

**Fit Time:** <1 hour

### Warning

1. Electrical connections must be secure and correctly routed before operating the vehicle. Loose or incorrectly fitted wiring may cause damage or fire.
2. Do not attempt to fit this wiring harness to your vehicle unless you fully understand these instructions. Please direct any questions regarding fitting to ALTIQ™ Support or to a reputable auto electrician.
3. Always ensure the vehicle's battery is disconnected before commencing installation unless otherwise instructed in the steps below.

### Checks and Maintenance

1. Inspect all connection points after driving a short distance following initial installation.
2. Re-check all connections at regular intervals — every 6 months is recommended, depending on road conditions, usage and distances travelled.
3. Off-road use is more demanding. Increase inspection frequency accordingly.
4. Ensure wiring is not chafing against any sharp edges, moving components or heat sources.

### Note for Dealers and Fitters

It is your responsibility to ensure these fitting instructions are given to the end user or client. These instructions remain the property of ALTIQ™ and may not be used or changed for any other purpose than intended.

### 1. Mount the Relay

Secure the relay in a dry, protected location in the engine bay, close to the battery. Ensure there is enough clearance below the relay for the wiring to drop away without bending at a sharp angle.

### 2. Connect to Battery

Remove the Fuse from the Fuse Holder. Connect the ring terminals to the battery: red to positive, black to negative. The inline fuse is on the positive line.

### 3. Connect the High Beam Trigger

H4 and HB3 piggyback adapters are included for halogen headlights. For Bi-LED or HID factory headlights, a vehicle-specific adapter is available separately.

- A. Plug the adapter into the high beam connector on the harness.
- B. Disconnect the factory power plug from your headlight globe.
- C. Connect the factory plug to the piggyback adapter.
- D. Connect the adapter back into the headlight globe.

### 4. Connect Your Light Bar

Plug the Fast Fit Harness output into your ALTIQ™ Light Bar. If your lightbar is ≤32", you'll need the included DT-P to DT adaptor.

### 5. Run the In-Cabin Isolator Switch

See Isolator Wiring Diagram on next page to ensure correct wiring.

The isolator switch allows you to run high beam without the driving lights active. This is required for ADR compliance.

To route the switch cable through the factory firewall grommet into the cabin, unscrew and unplug the Waterproof Connector (shown in diagram), pass the small plug through the grommet, reconnect, and mount the switch in a convenient location.

### 7. Tidy & Test

- A. Tidy all wiring with cable ties, keeping cables clear of moving parts and direct heat sources like the engine block and exhaust.
- B. Push the Fuse firmly into the Fuse Holder until fully seated.
- C. Start the vehicle. Turn on the headlights and activate high beam. The light bar should illuminate. Confirm the isolator switch turns it on & off independently of high beam, and that it also turns off when dropping back to low beam.

### Isolator Switch

**WARNING: Incorrect wiring will lead to harness failure**

- |   |  |   |
|---|--|---|
| <b>Pin 1</b><br>Gold pin, Black wire, Negative/Ground | <b>Pin 2</b><br>Silver pin, Blue wire, Accessory-switched 12V source | <b>Pin 3</b><br>Silver pin, White wire, Constant 12V source |
|---|--|---|

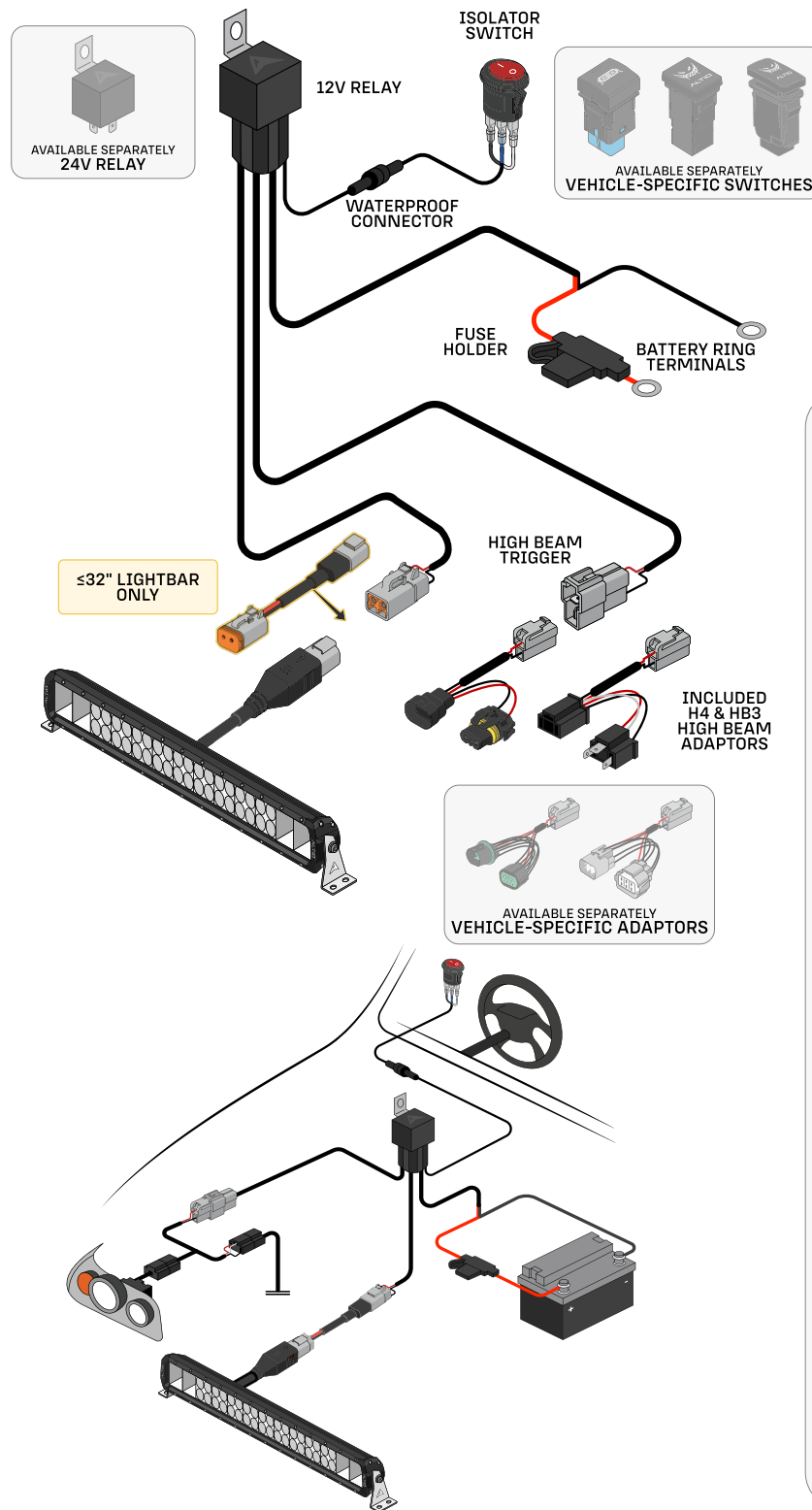
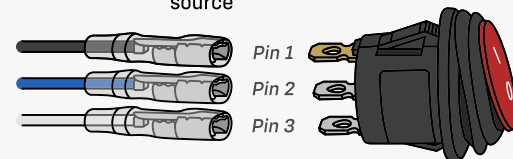

### Side Mount Brackets

Follow the diagram for installation order of the included hardware.

Ensure the black plastic washer is utilised as it is essential.

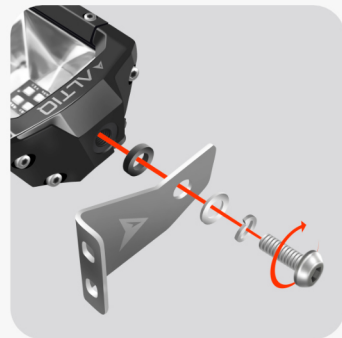

### Under Mount Brackets

#### Single Row

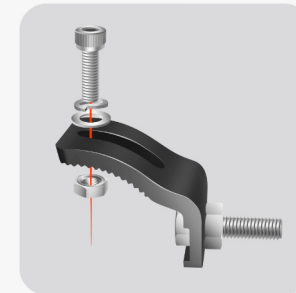

#### Double Row

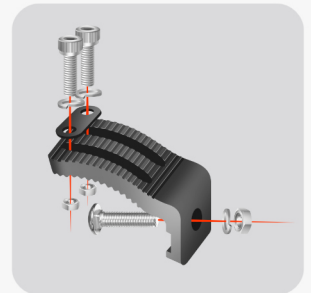

Loosely fit both nuts and hardware to the brackets.



Move the bracket into position

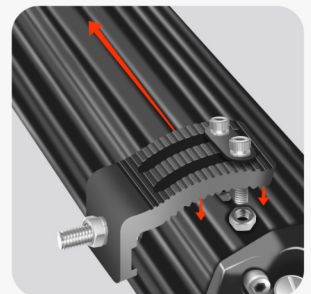

Put nut into channel and thread the bolt into it.

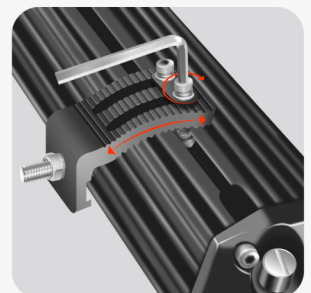

Do final tightening when in position.