



FORD RAPTOR RANGER EVEREST

NEXT GEN

SPOT LIGHT STEALTH KIT

INSTALL GUIDE



ALTIQ



NEXT-GEN SPOT LIGHT STEALTH KIT INSTALL GUIDE

Unparalleled stealth lighting for your Next-Gen Ford Raptor, Ranger or Everest.
The ALTIQ™ bracket is engineered with maximum compatibility in mind, with a no-compromise design to cooling, fitment and function.



Spot Light Stealth Kit for Next-Gen Ford Raptor, Ranger & Everest

This guide shows you how to install your ALTIQ™ Rogue Mk3 spotlights with our Stealth bracket system and Fast Fit wiring harness. It covers all supported Next-Gen Ford models and headlight configurations: Level 1, Level 2, Level 3 headlights, and vehicles with factory AUX overhead switches.

What's Included

- Stealth Bracket System (3 pieces)
- ALTIQ™ Rogue Mk3 Spotlight pair
- ALTIQ™ Rogue Mk3 Grey Fascias - other colours available separately
- ALTIQ™ Fast Fit Dual Output Wiring Harness
- ALTIQ™ High Beam Adapter or AUX Trigger Wire / Footwell High Beam Trigger Wire
- Fuse Tap for DRL
- Mounting Hardware

PREPARATION

A. Park the vehicle on flat, level ground facing a wall or garage door (~5m away) - you'll need this later to align your lights.

! WARNING:

B. Disconnect the battery before removing the grille. Unplugging the grille camera socket with the battery connected will trigger a fault requiring dealer recalibration. **Leave the battery disconnected** until the grille camera socket is reconnected in Section 7.

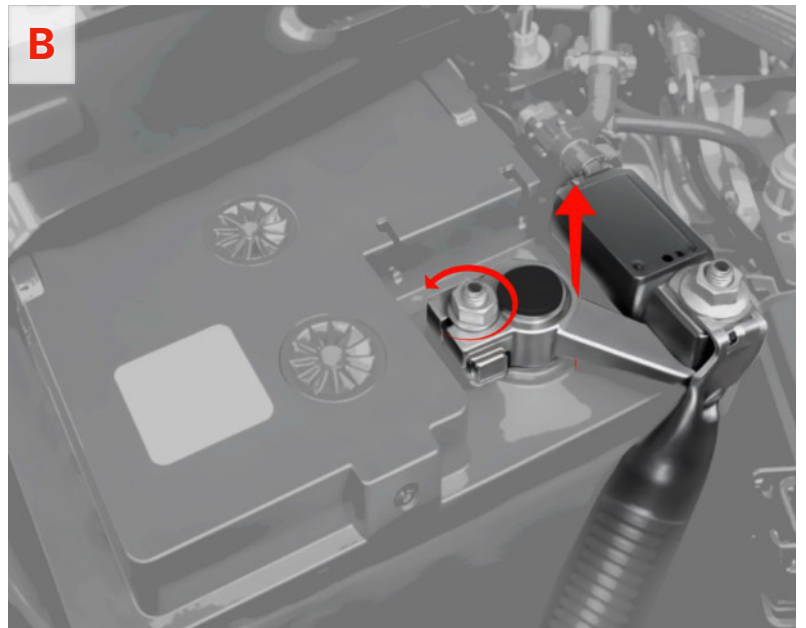

BRACKET ASSEMBLY

A. Place the spotlights face down (to prevent the nuts and retainer from sliding out) on a clean bench, and remove the four included mounting bolts.

B. Mount the Stealth bracket system to the lights using the supplied bolts, washers, and Nyloc nuts.

Note: Don't fully tighten bolts on the sides of the lights, as we'll adjust the angle of the lights in the alignment step.

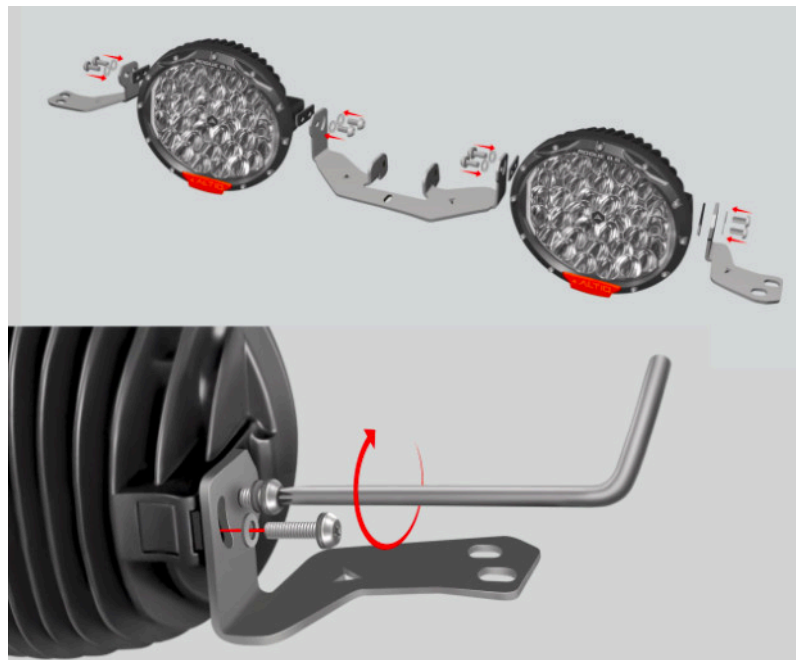

A. Confirm the vehicle battery is disconnected, then remove the 13 clips securing the top trim panel above the grille.

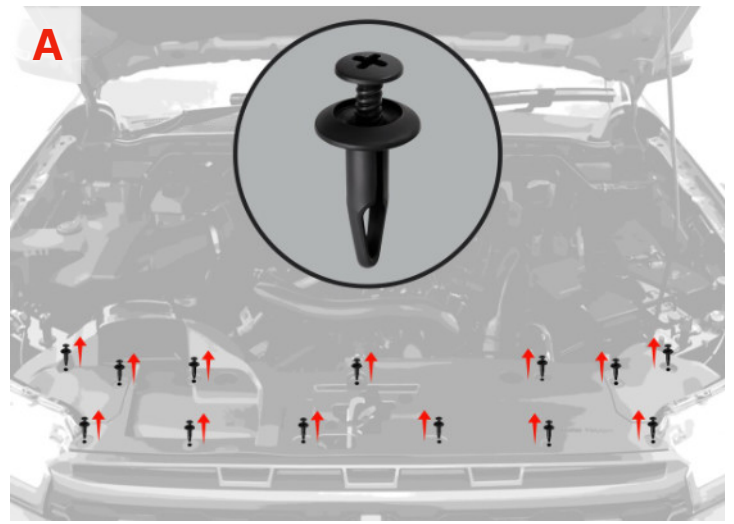

B. (Raptor only): Remove the lower trim piece using a trim tool.

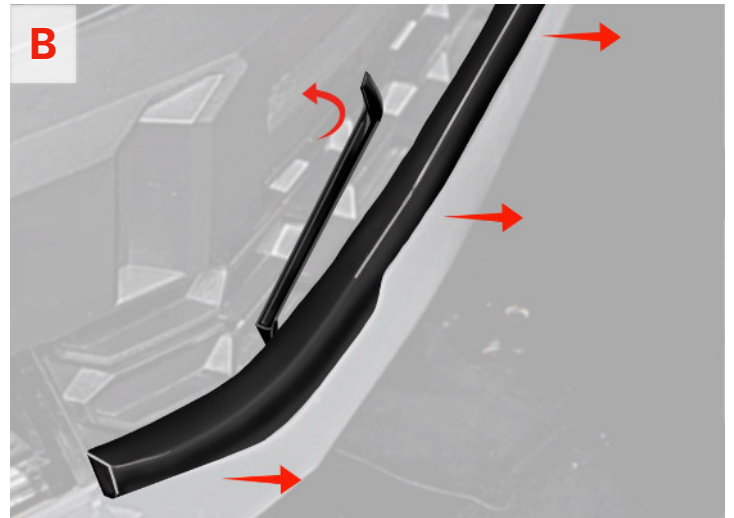

C. All models: Remove the two 8mm bolts from the top of the grille.

Raptor only: Remove the three 8mm bolts from the bottom of the grille that were revealed in the previous step.

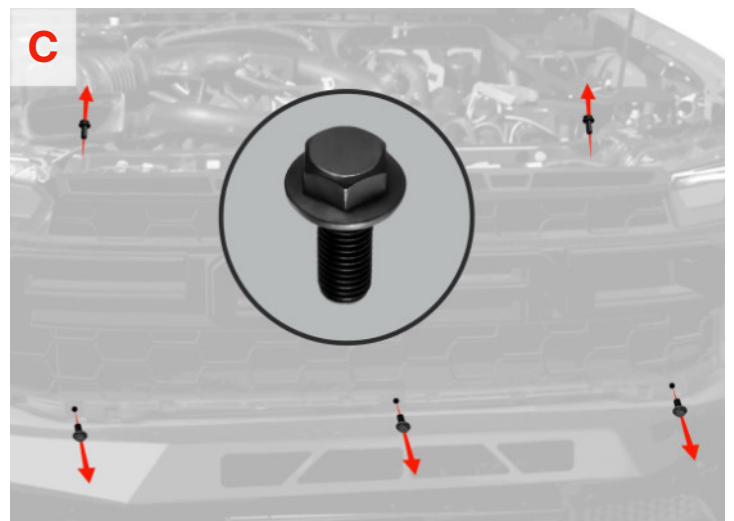

D. Disconnect the camera plug & washer hose, then carefully pull the grille forward to release the clips and remove. Set it aside carefully to avoid scratching it.

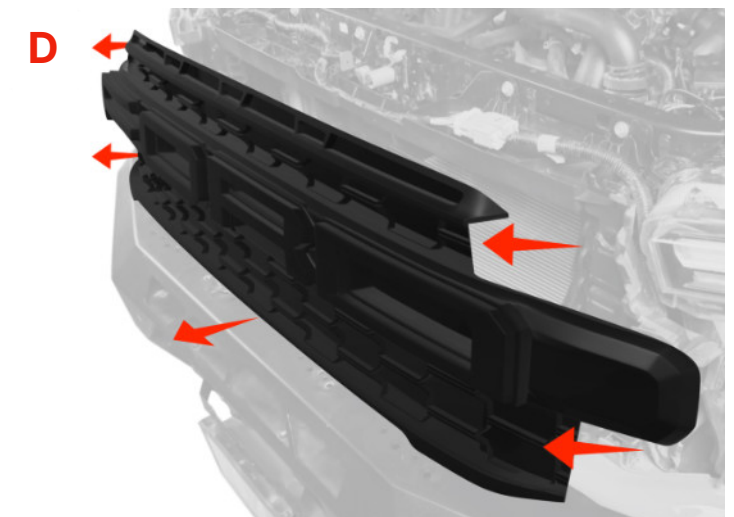

A. Remove the factory 2× 10mm bolts and 2x clips.

B. Mount the Stealth brackets with attached Rogue lights, and secure with the same bolts and clips.

C. Secure the centre bracket using the supplied 3x hex-head bolts, washers, spring washers, and nyloc nuts.

Note: The centre bracket has depth adjustment. Place a flat bar or spirit level across the face of both lights to ensure they're not pointing inwards or outwards. Push or pull the centre bracket until the lights are straight, then tighten the centre bracket bolts. The vertical tilt angle will be adjusted later during alignment.

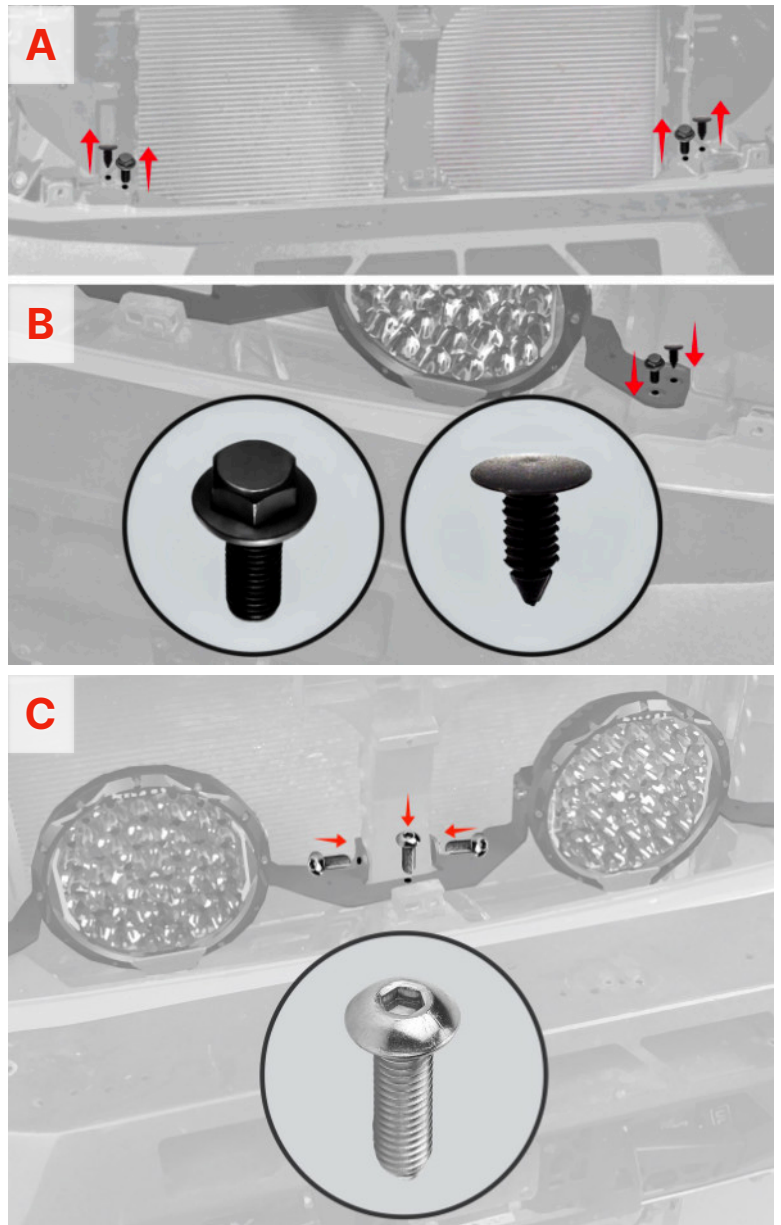

A. Route the twin DT-P plugs on the Fast Fit Harness to each Rogue Mk3 light behind the grille (use the opening on the driver's side near the radiator) and plug them in.

B. Remove the fuse from the harness fuse holder, then find an appropriate chassis ground for the ground ring terminal and connect the positive ring terminal to the battery.

C. Install the isolator switch in-cabin within easy reach of the driver. Undo the waterproof disconnect for easier cable routing. Firewall grommet is located on the passenger side. Pass it through the grommet not around it, otherwise it will let water into the cabin.

⚠ WARNING: Isolator Switch Pin Order

Be careful with the pin/wiring order, as getting it wrong WILL result in catastrophic harness failure. **The correct pin/wire order is:**

Pin 1 (Gold) Black wire, Pin 2 (Silver) Blue wire, Pin 3 (Silver) White wire.

D. To route and connect the high beam trigger, identify which guide you need to follow, then refer to the following pages for step-by-step instructions.



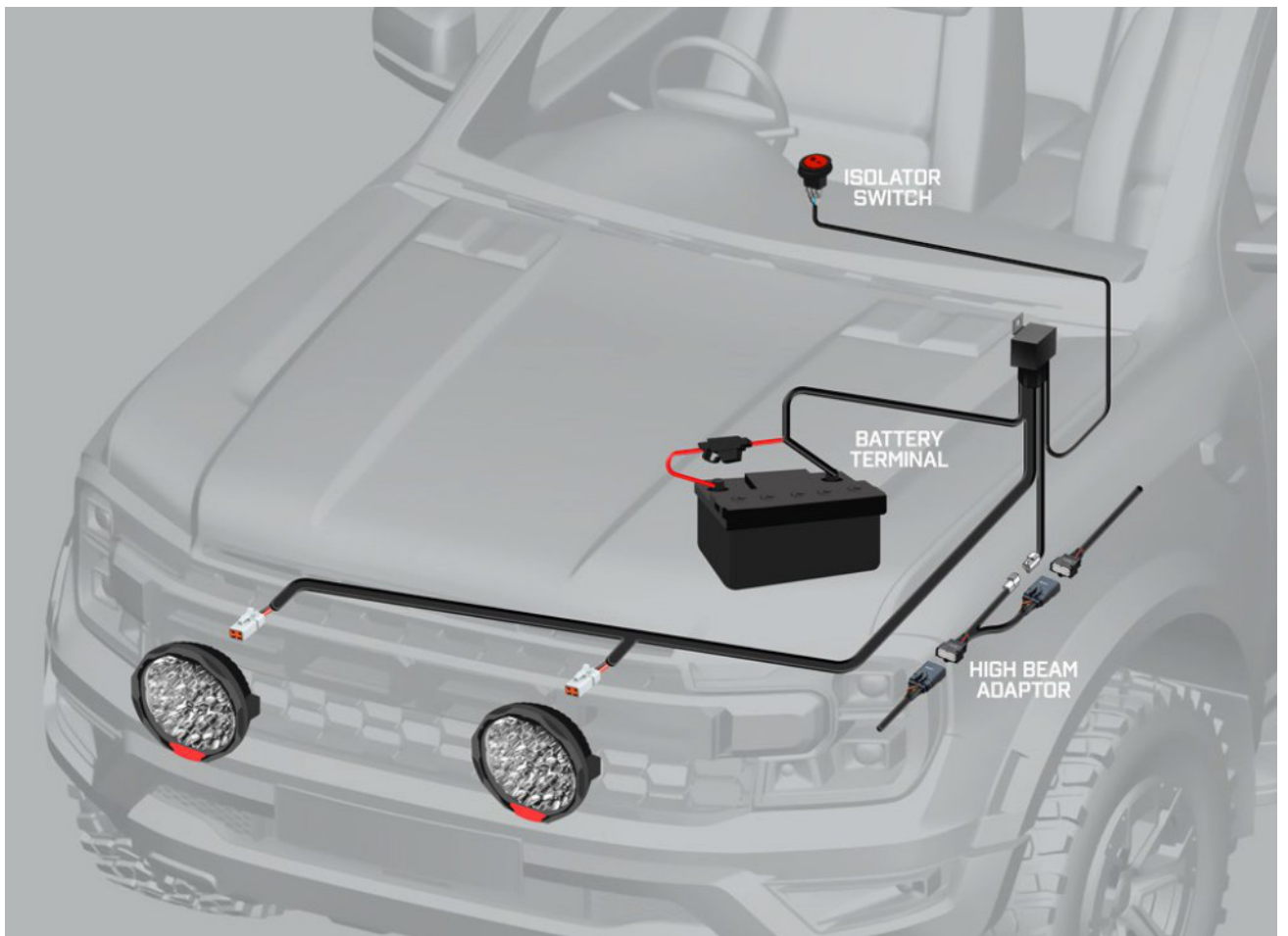

Level 1 & Level 3 Headlights

You'll Need:

- ALTIQ™ Next Gen Level 1/3 High Beam Adapter
- ALTIQ™ Dual Output Fast Fit Harness

Steps:

- a. Connect the High Beam Adapter between the passenger-side headlight and the factory harness by unplugging the loom and inserting the adapter.
- b. Connect the white T-plug socket from the adapter to the Fast Fit Harness. This ensures the harness activates only when high beams and the isolator switch are on, per ADR regulations.
- c. Proceed to **Section 6** to connect the yellow DRL wire.

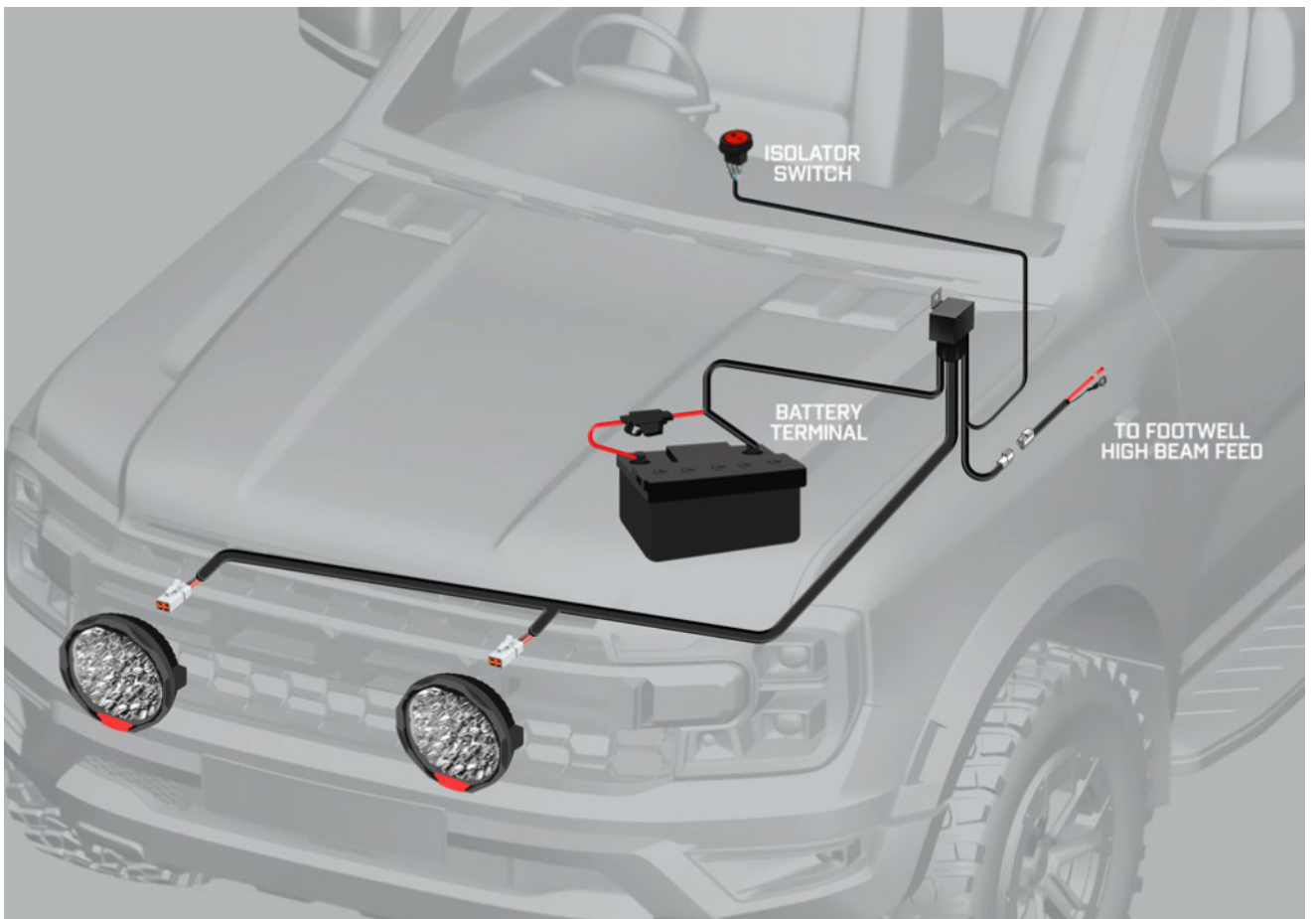

Level 2 Headlights

You'll Need:

- ALTIQ™ Next Gen Level 2 High Beam Adapter
- Fast Fit Harness

Steps:

- Route the high beam T-socket trigger wire through the firewall into the passenger footwell (grommet behind battery on passenger side).
- Connect it to the factory labelled high beam feed wire as shown below.
- Proceed to **Section 6** to connect the yellow DRL wire.

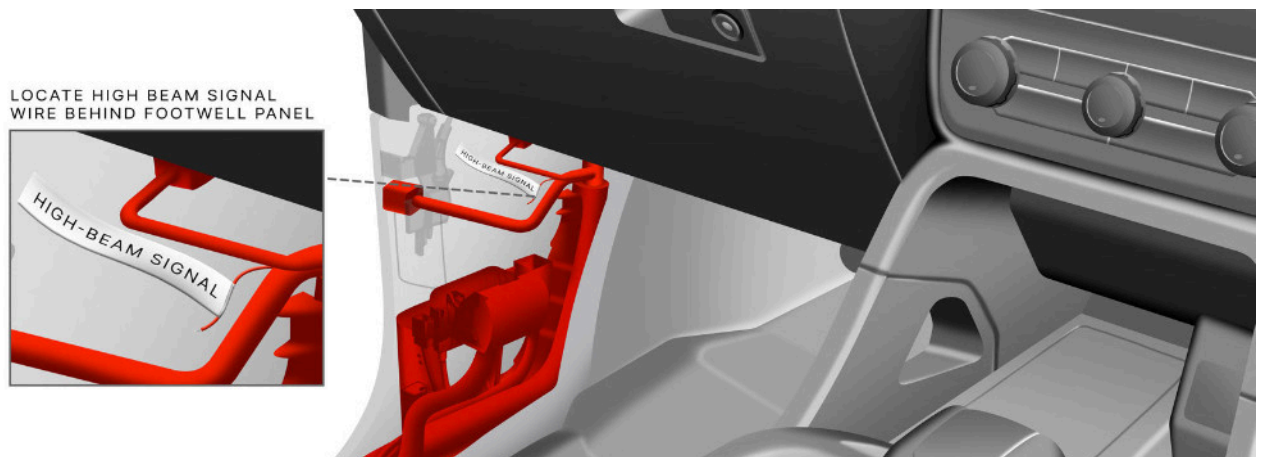

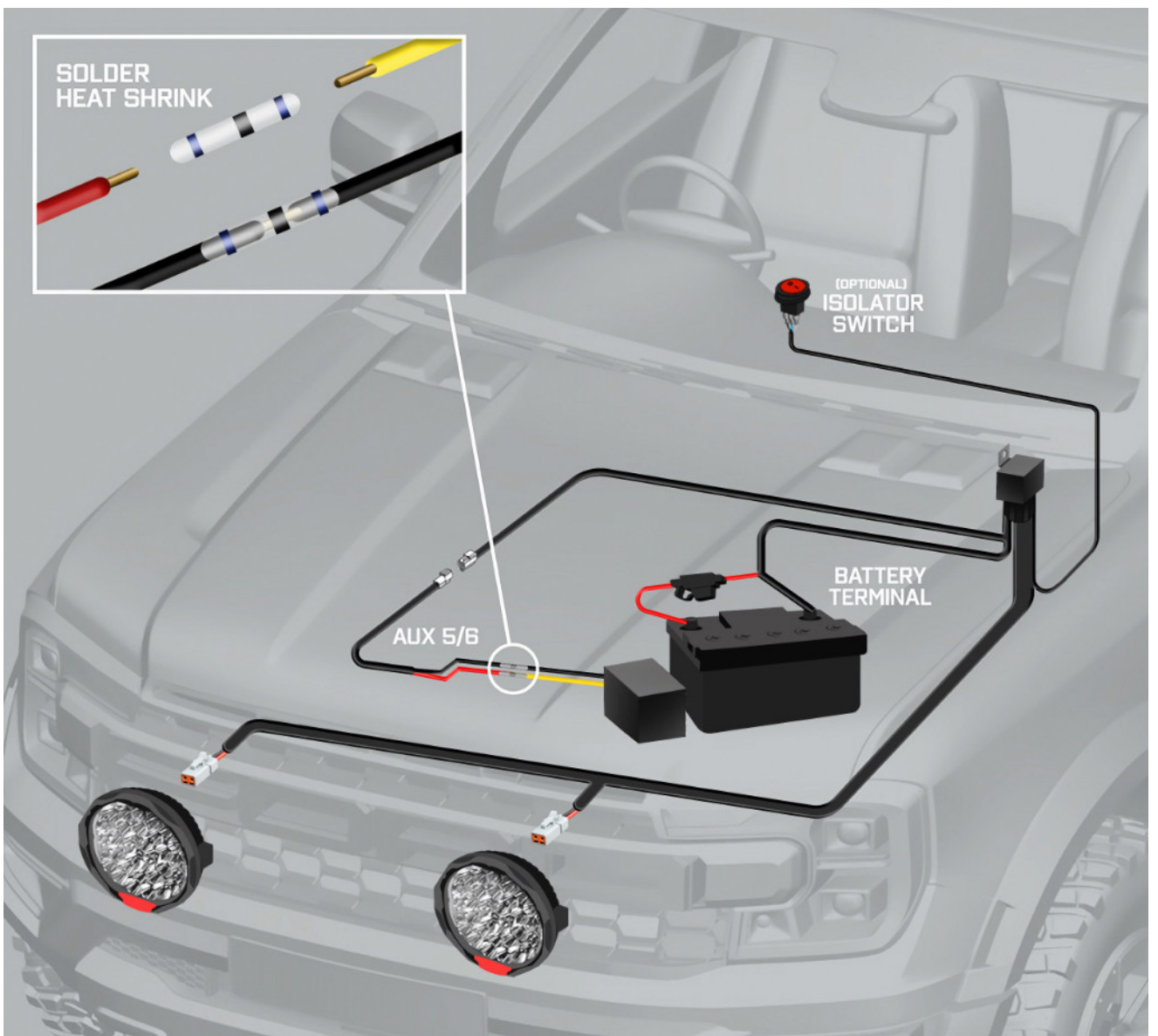

AUX Overhead Switches

You'll Need:

- ALTIQ™ Next Gen AUX Trigger Wire
- ALTIQ™ Dual Output Fast Fit Harness

Steps:

- Connect AUX 5 or 6 output in the engine bay to the high beam trigger wire of the Fast Fit Harness. Use the included heat shrink to insulate the connections. Heat with a heat gun - avoid open flames.
- (Optional): Coil isolator switch in the engine bay (set ON) or route into the glove box as a secondary cut-off. The overhead AUX switch becomes your main isolator. Alternatively, you may terminate the isolator circuit by joining blue to white and insulating black (negative) - this remains ADR-compliant as the lights are still isolated via the AUX switch.
- Proceed to **Section 6** to connect the yellow DRL wire.

AUX 5 & 6 activate only when both the AUX switch and high beams are on.

Note: AUX 5/6 outputs cannot handle two Rogue Mk3s directly - they serve as signal inputs only. The Fast Fit Harness powers them safely.

A. Locate the fuse box near the firewall on the passenger side and open it.

B. With the battery still disconnected, (1) remove the indicated **red 10A fuse**, (2) insert original fuse into the tap, (3) then insert the fuse tap in the now empty slot in the fuse box.

C. Run the wire from the fuse tap down to the spot lights.

D. The wire splits into two ends, use one for each light. Connect them to the Yellow DRL Wire off the back of the Rogue's.

E. Secure them by either soldering plus heatshrink / electrical tape, or by using Heat Activated Solder Sleeves.

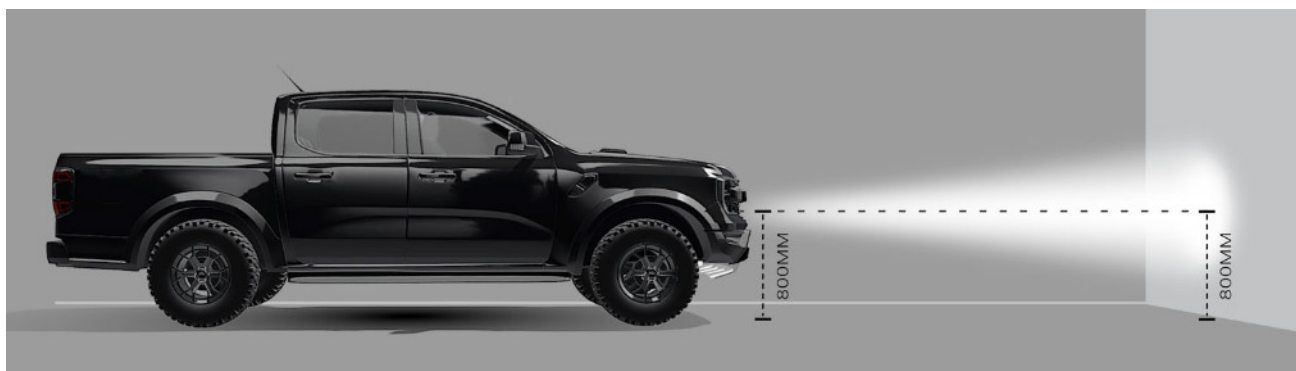
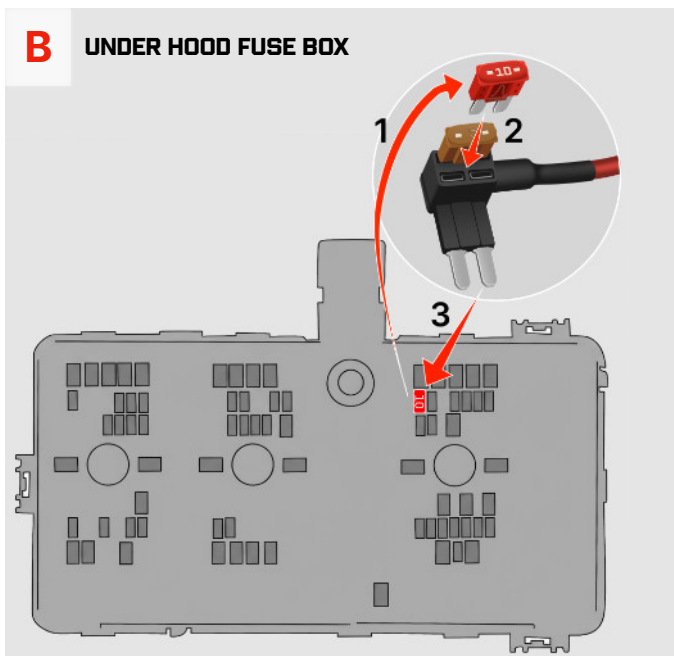

! WARNING:

Before reconnecting the battery, ensure the grille camera socket is plugged back in.

1. Plug the front grille camera back in and rest the grille on a towel in the engine bay
2. Reconnect the vehicle battery.
3. Insert the fuse into the harness fuse holder and close it.
4. Turn ignition ON (Warning: DO NOT start engine while grille is resting in engine bay as it may fall and get damaged).
5. Switch on high beams - Rogue Mk3 lights should illuminate. Ensure you turn on the isolator switch (and AUX switch for AUX cars). For constant high beams, rotate the headlight dial from Auto to ON.
6. Measure from the centre of each Rogue Mk3 lens (ALTIQ™ logo is in the centre) to the ground, and mark that same height on a wall or door. See diagram above for reference.
7. Adjust the lights so the brightest hotspot sits at the same level as the marked height.
8. Tighten all bolts, checking the lights don't move out of alignment:
 - Hex bolts to 10 Nm
 - Security Torx bolts to approx 22 Nm
9. Turn ignition OFF.

- A. Verify all bolts you installed on the lights and brackets are tight.
- B. Reinstall the grill by pushing on it carefully to engage clips
- C. Connect washer hose
- D. Secure grille with 2× 8mm bolts at the top.
- E. For Raptor only, put in the 3x bolts at the bottom, and push the trim piece back on, ensuring all clips engage.
- F. Install top trim panel above grille with the 13 clips.
- G. Confirm washer hose and camera plug is securely attached, no wires are pinched, and the grille is secure.
- H. Test lights once more.



Well done!

Now all that's left to do is enjoy your new unparalleled stealth lighting system on the open road.

If you need help with anything, please contact our team at sales@altiq.com.au or call us on (03) 9071 2990 for assistance.



ILLUMINATE THE UNCHARTED_

ALTIQ.COM.AU
SALES@ALTIQ.COM.AU
03 9071 2990